

Visual Presenter User Manual



**** Please read this user manual carefully before using the product ****

Contents

Attention to safety issues.....	3
Accessories List.....	3
Introduction.....	4
Interface and Device connection.....	5
Button Panel and Remote	6
Questions	7
Technical parameters	8
Mouse operation software.....	9
System Settings.....	10-11



Attention to safety issues



★ Power

This product uses DC 12V power supply. You must notice the safety of electrical wire and electrical outlet, when there is any damaged please replace or repair it immediately.

★ Clean up

Please keep this presenter always clean. Keep this product away from water, oil, dust, caustic gas to allow this intelligent visual presenter work perfectly.

★ Shake proof

Prevent collision, nick or dropping .When you press any key and switch, you shouldn't overexert to allow this presenter work perfectly.

★ Transportation

You can use any vehicle to transport the product under packed, but should avoid rain, snow and any huge bump.

Attentions

- ◆to extend the using time of this product ,please turn off the power supply after you have done your jobs.
- ◆non-professional person should not unwrap this machine,because it contains strong electricity. You must be responsibility for wrap this machine privately.
- ◆Please use this machine under the guidance of this manual.

Accessories list

◆ machine:	x1
◆Adapter:	x1
◆HDMI cable:	x1
◆ VGA cable:	x1
◆ USB cable:	x1
◆ Remote control:	x1
◆TF Card (including software and user manual) :	x1

Introduction

- ◆ The visual presenter has 10x optical ,10 x digital (total 100x) zoom 、 File shooting range: A3,auto/manual focus,auto white balance,color adjustment etc.picture processing function.multi-way input and output ports so that can be connected with our media devices and switch the program.
- ◆ Varies ways to control:interface、 IR remote control 、 software.
- ◆ Built-in Linux operating system,Visual presenter through mouse operation can achieve ideo recording, taking photos, annotation, comparison with the screen, rotation ,image freeze and other functions。
- ◆ Support external computer access and switching , HDMI and VGA output, Supports 1920*1080@60Hz, 1280*1024@60Hz, and 1024*768@60Hz resolution output; 4k type support 3840*2160@30Hz(HDMI port), 1920*1080@60Hz resolution output.
- ◆ Built-in MIC and external audio, Support HD video recording, 4K type takes 8-megapixel photos and videos.
- ◆ External power:safety,convenience and energy conservation.

Equipment List

Open the box

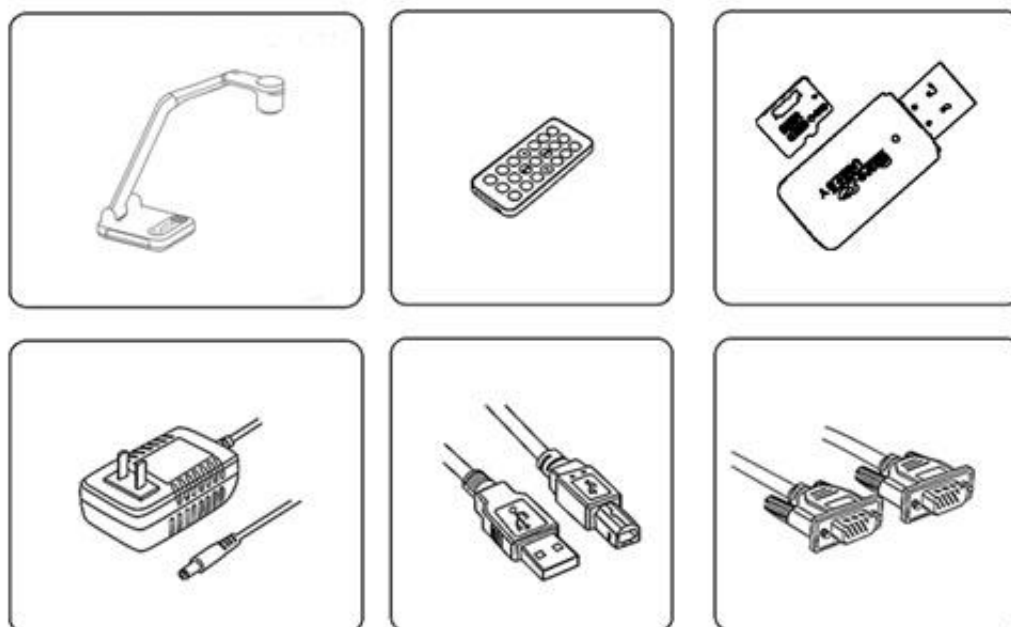

*** No battery is installed on the remote control.**

Interface



DC12V: Power input, external power adapter

USB : Connect to USB port of computer (Use of supporting software)

AUDIO OUT: Audio output

VGA OUT: VGA signal output, connected to display screen, projector and other display equipment



VGA/HDMI IN: External VGA signal input, connected to computer host or laptop

AUDIO IN: Audio in

HDMI OUT: HDMI signal output, with HDMI interface HD display device

TF: TF card for storing videos or pictures

USB MOUSE: Connect the mouse for software operation

Device connection

Connect the power adapter to the DC 12V power port. The visualizer indicator is red, and its in low-power standby state. For the device to work safely, be sure to use the power adapter provided by the manufacturer.

VGA/HDMI port: The monitor or projector device is connected to VGA / HDMI OUT in the visualizer with VGA/HDMI cable, external PC host or laptop is connected to the VGA/HDMI IN port.

USP port: Connect to USB port of computer via USB cable, If you use a desktop computer, the USB interface on the back of the computer will be more stable.

Note: HDMI and VGA output ports can be used simultaneously.

Button Panel

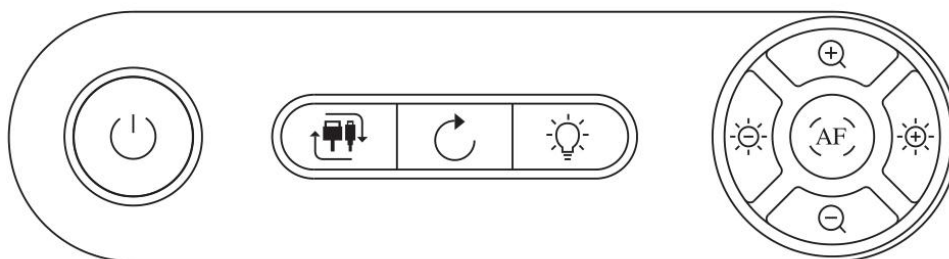

- : Power Switch
 : Source Switch
 : Rotate the image 180 degrees
 : Lighting
 : Zoom In
 : Zoom Out
 : Bright+
 : Bright-

Remote Control Panel

- Power:** On/off the visual presenter
Lamp: turn on/off the lamp of the presenter
Source: Camera / VGA1 / VGA2 / HDMI
Resol: Resol (Switch) / XGA(1024*768) / 1080P(1920*1080) / 4K
Replay: Mouse operation **Exit:** Exit menu **Snap:** Take pictures
Record: Record video **TELE:** Zoom In **WIDE:** Zoom Out
NEAR: Turn the focus near **FAR:** Turn the focus far
AF/ ENTER: **AF:** auto focus
Enter: confirm the button after selecting the function
B. W/C: Black&white / Color **BRI-:** Bright Down **BRI+:** Bright UP
TEXT: Text mode (Defaults to picture mode), more clearly in text status,more colorful in picture status.
SHARP-: Sharp Down **SHARP+:** Sharp Up
FREEZE: Freeze the picture **NEGA:** Negative
SPLIT: Split screen , live on the left, freeze on the right.
RESET: Restore defaults **MIRROR:** Horizontally reverse the picture
ROTATE: Rotate the image 180 degrees



Output Resolution

System resolution setting in the software or IR remote control resolution menu setting

XGA: 1024*768 (4:3)

1080P: 1920*1080 (16:9)

4K: 3840*2160 (16:9) (4K type)

FAQ

Questions	Measures
No sound/ No image	<ul style="list-style-type: none">● Check the power supply wire is connected or not;● Check the power supply is turned on or not;● Whether the monitor is powered on and working properly● Please check if the inputs and output interfaces are connected correctly;● Whether to switch the source to the external computer, press the signal switch button on the panel to try;● Restore factory Settings;
The key-press on the control panel dose not work	<ul style="list-style-type: none">● Check whether the screen is in the image freeze state;● Whether to switch the source to the external computer, press the panel of the presenter key to try;
Remote control is unstable	<ul style="list-style-type: none">● Operate the remote control close to the presenter;● Check whether the battery of the remote control is installed;● Replace the battery of the remote control;● Try it in different positions;
The image's not clear	<ul style="list-style-type: none">● Please check whether the lens is dirty, if so please clean the lens with cotton cloth or put the object nearer to the lens ;● Perhaps the object is too near, if so please make sure the distance between the object and the lens is over 10mm;● Perhaps the object is too bright or of bright surface, if so please modulate light outside;

Technical Parameters

model	HD	4K
Imaging device	1/2.8 inch Sony CMOS	1/2.8 inch Sony CMOS
Total pixels	2 MP	8MP
Horizontal Resolution	1000TV line	1600TV line
Zoom	10X optical zoom, 10X digital zoom	10X optical zoom, 10X digital zoom
Focus	Automatic / manual	Automatic / manual
Aperture	automatic	automatic
White balance	automatic	automatic
Image Processing	Color / black and white, mirroring, text / image, brightness adjustment, image freeze, zoom in / out	Color / black and white, mirroring, text / image, brightness adjustment, image freeze, zoom in / out
IR remote control	Standard	Standard
HDMI resolution	XGA、SXGA、1080P	4K、1080P
VGA resolution	XGA、SXGA、1080P	XGA、SXGA、1080P
VGA/HDMI frame rate	1080P@60fps(maximum)	3840*2160P@20fps(maximum) 1080P@30fps
Resolution	1920*1080	4K (3840*2160) / 1920*1080
USB video stream format	MJPEG , 1920*1080@30fps	3840*2160 @ 15fps 1080P@30fps
File shooting range	A3 and below	A3 and below
input interface	VGA*1 , HDMI*1 , Audio*1	VGA*1 , HDMI*1 , Audio*1
Output Interface	VGA*1 , HDMI*1 , Audio*1 USB2.0*1	VGA*1 , HDMI*1 , Audio*1 USB2.0*1
TF card	Support	Support
USB Mouse	Support	Support
Operation function by mouse	Annotation, Auto focus, Zoom in, Zoom out, Take photos, Video, Video playback, Split screen, Picture in picture, Freeze, Title, Rotate, Image, Text,etc.	Annotation ,Auto focus, Zoom in, Zoom out, Take photos, Video, Video playback, Split screen, Picture in picture, Freeze, Title, Rotate, Image, Text,etc.
Auxiliary light	LED lights, three-level dimming	LED lights, three-level dimming
Operating Voltage	12V (external DC12V power adapter)	12V (external DC12V power adapter)
Booth volume	Folding: 373.5*110*160mm Unfolding: 448*385*160mm	Folding: 373.5*110*160mm Unfolding: 448*385*160mm
net weight	2.80KG	2.80KG
Package dimensions	400*155*208mm	400*155*208mm

* Note: The specification may change from time to time, so please refer to the updated products.

Mouse operation software

Click the right mouse button to show the menu,.Stop operations for 30 seconds. The menu is automatically hidden. Menu functions and notes are shown in the following figure.



	Annotation		Auto Focus		Zoom In		Zoom Out
	Local Zoom		Title		Rotate		Freeze
	split screen		Picture in Picture		Picture or Text		
	Black & White		High Light		Cover		
	Photograph		Video		Photo		
	Video playback		System Settings		Manual		



	HomePage		Photograph		Pencil		Eraser Tool
	Undo		Redo		CLS		
	Graphic Properties		Line Width				
	Color Attribute		Board Attribute				
	Real Time Image						



System Settings

The Settings menu contains: **Lens** / **AWB** / **Display** / **Function** / **System**

Lens:

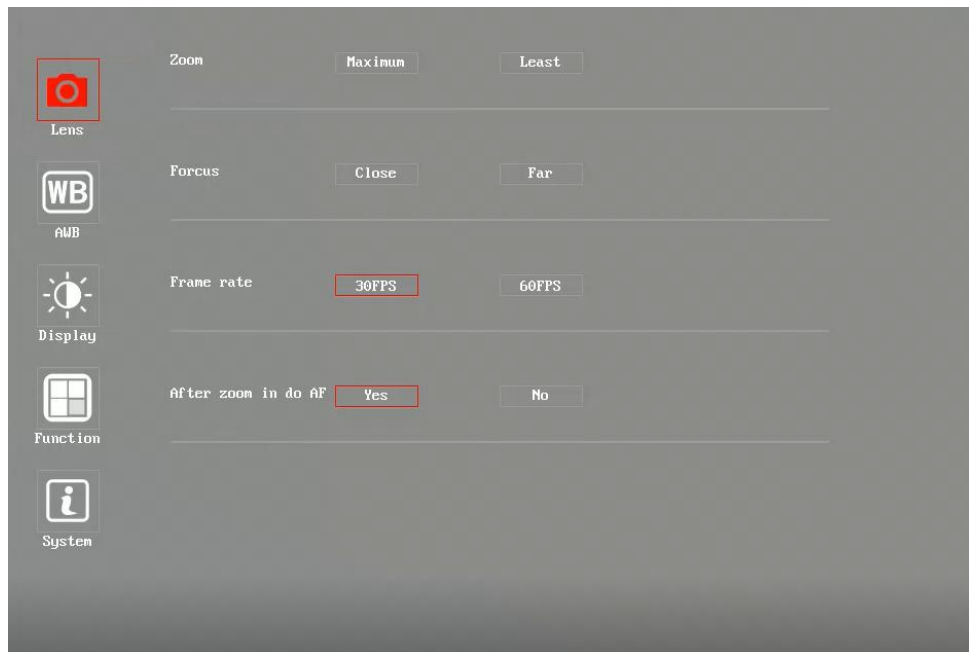

AWB: Adjust automatic white balance and manual white balance as required

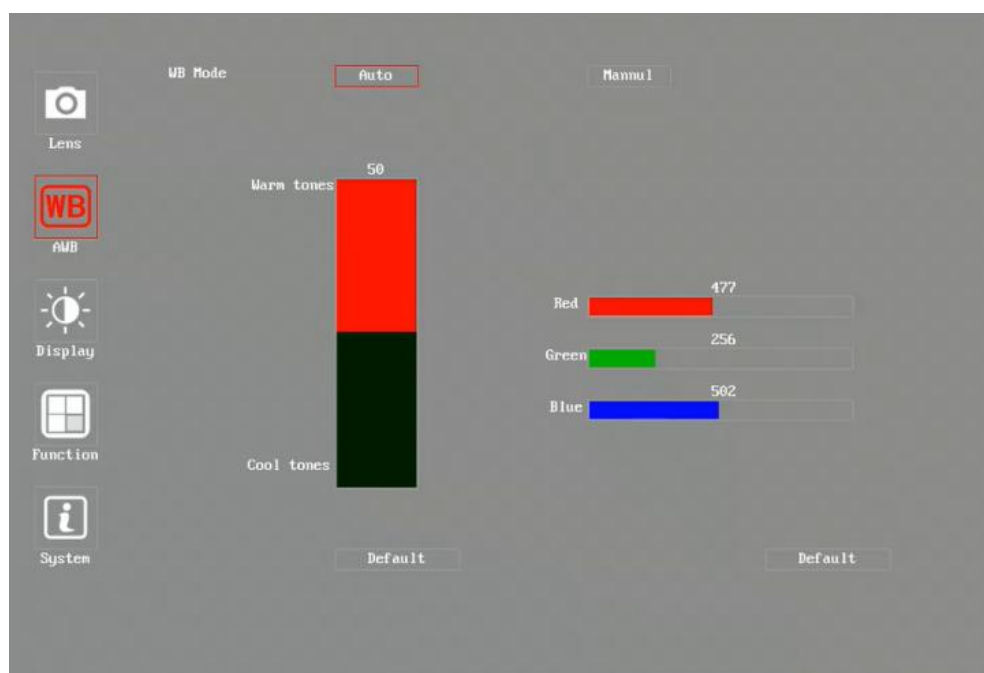

Display: Image parameter



Function:

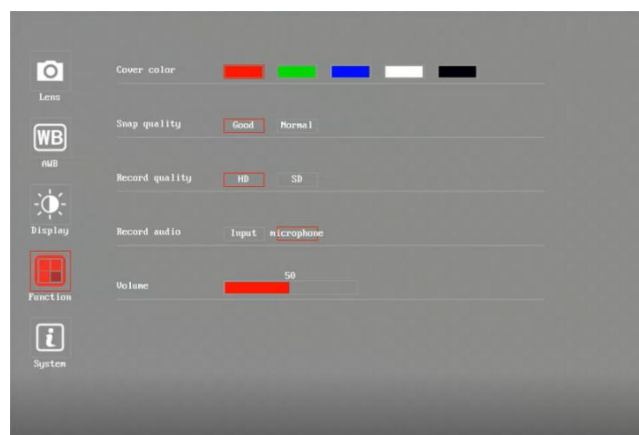

System: 1080P & 4K

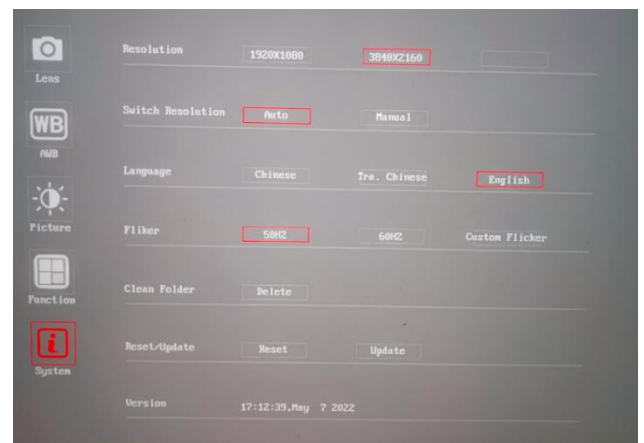
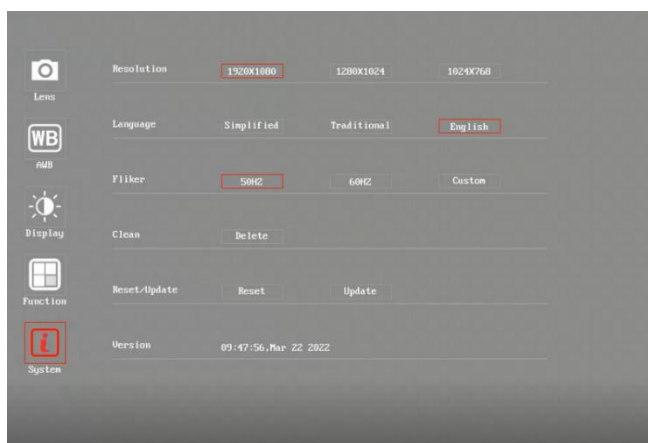

Note: The specification may change from time to time, so please refer to the updated product.

Hangzhou Gaoke Industry&Trade Co.,Ltd.(1992-2025)

Add: Building A6, Phase I, Cainiao Zhigu Industrial Park, No.2-150 Yunlian Road, Yuhang District, Hangzhou, China

Tel: +86 571 8998 6945

Web: www.hzgaokegroup.com

Email: gaoke@hz-gaoke.com